

STRAIGHT ADAPTOR R M – R M

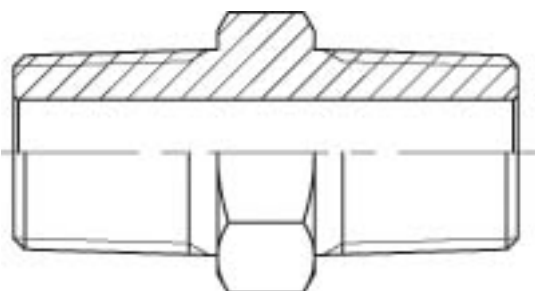

Material
Adjustable
Bulkhead
Shape

Steel
No
No
Straight

Part no	Thread 1	Thread 2	Weight (kg)
70230404	R 1/4" Male	R 1/4" Male	0.02
70230408	R 1/4" Male	R 1/2" Male	0.06
70230606	R 3/8" Male	R 3/8" Male	0.04
70230808	R 1/2" Male	R 1/2" Male	0.08
70231616	R 1" Male	R 1" Male	0.2

