

GMxGM

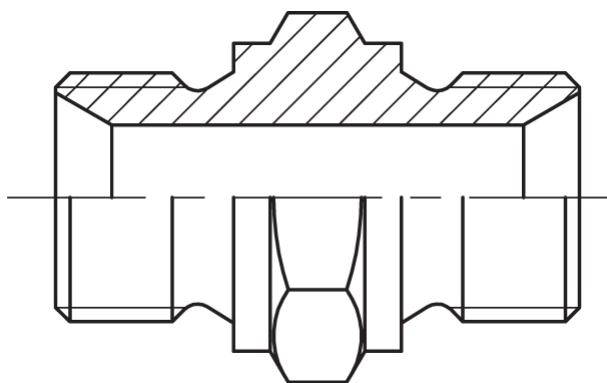

Product info

Product group

Material

Adjustable

Bulkhead

Shape

Adapter type

60° cone sealing. DIN 3852, A.

780

Stainless Steel AISI 316

No

No

Straight

BSP

Part no	Thread 1	Thread 2	Weight (kg)
78020202	G 1/8" Male	G 1/8" Male	0.02
78020204	G 1/8" Male	G 1/4" Male	0.03
78020404	G 1/4" Male	G 1/4" Male	0.04
78020406	G 1/4" Male	G 3/8" Male	0.05
78020408	G 1/4" Male	G 1/2" Male	0.07
78020606	G 3/8" Male	G 3/8" Male	0.05
78020608	G 3/8" Male	G 1/2" Male	0.08
78020612	G 3/8" Male	G 3/4" Male	0.11
78020616	G 3/8" Male	G 1" Male	0.2
78020808	G 1/2" Male	G 1/2" Male	0.09
78020812	G 1/2" Male	G 3/4" Male	0.11
78020816	G 1/2" Male	G 1" Male	0.18
78021010	G 5/8" Male	G 5/8" Male	0.11
78021212	G 3/4" Male	G 3/4" Male	0.12
78021216	G 3/4" Male	G 1" Male	0.2
78021616	G 1" Male	G 1" Male	0.2
78021620	G 1" Male	G 1 1/4" Male	0.38
78022020	G 1 1/4" Male	G 1 1/4" Male	0.41
78022024	G 1 1/4" Male	G 1 1/2" Male	0.42
78022424	G 1 1/2" Male	G 1 1/2" Male	0.53
78022432	G 1 1/2" Male	G 2" Male	0.69
78023232	G 2" Male	G 2" Male	0.72

